



Conservation Notes

Providing Natural Resource Leadership

District Receives Forest Stewardship Award

By Tim Stieber

Several Yamhill SWCD Directors and staff were on hand November 23rd at the World Forestry Center in Portland to receive the Oregon Tree Farm System's "Outstanding Tree Farmer Award" for 2009. The district was a regional candidate competing for



Oak Savannah Restoration Project

the state-wide award which was won by a Linn County Tree Farm this year. Yamhill SWCD's Miller Woods was previously designated as the county winner for certified Tree Farm of the Year by Yamhill County's Small Woodland Association. The award recognized current and past management of Miller Woods forest resources, the district comprehensive planning efforts, and the districts work to educate citizens about sustainable forestry practices.



Replanted and cared for Douglas Fir Plantation

Significant Donations To Conservation

This past month the **Willamette Habitat Restoration Fund** supported a project that Yamhill SWCD and US Fish and Wildlife Service have planned for enhancing Kincaid's Lupine and Fenders's Blue Butterfly habitats. The funding donated by WHR, purchased

about 2000 plants, of seven native flowering forb species, that are being planted on 5 landownership's, to enhance nectar plant food resources for butterflies.

Crown Hill Farms made a donation of a wood stove and liner system that was installed in the Miller Woods residence. The combination of an efficient wood heating system and changing the aluminum frame windows in the residence to energy efficient ones has conserved significant energy and reduced the electric bills significantly.

Tom Brewster retired from the Farm Services Agency a few years ago and has since helped district staff complete several conservation projects. His area of specialty is bird houses and other wildlife structures such as bat and squirrel boxes and waterfowl nesting platforms. Tom has a passion for designing and building bird boxes and recently donated 10 boxes to be used at Miller Woods to establish a nesting box network.

Yamhill SWCD staff and directors greatly appreciate these donations and the time our volunteers donate to the program.



Female

Fenders Blue Butterfly

POSTERS AVAILABLE for Pre-Order!!!

A lot of posters are available on our preorder sheet this year. Pictures of these posters can be found on the back page of this newsletter as well as on our website at www.yamhillswcd.org. Posters are discounted (approximately 40% off) for Pre-Order's ONLY. So get them while supplies last!

Plant Sale Volunteers Needed

This year's annual event offers a great opportunity to show off your volunteer spirit. Proceeds from this year's sale will go toward Miller Woods education program! Irma Koyama will be coordinating volunteers (Contact info below). Help is needed as follows: **Feb 4, 5 : 8am-5pm** for plant labeling & table set up. **Feb. 8-10 : 8am-5pm** for filling of pre-orders. **Feb. 11-13 : 8:30-6pm**. Sale Days: help with customers orders. **Feb. 15-17th : 10am-3pm** for follow-up on orders & Clean Up. Even helping for a few hours on one day will be appreciated.

CONTACT IRMA KOYAMA 503-472-6403 OR

YAMHILLSWCD@VERIZON.NET



The Conservation Notes are published by Yamhill Soil and Water Conservation District 2200 SW 2nd Street McMinnville, OR 97128 Tel.: (503) 472-1474 x102 Fax: (503) 472-2459 Josie.reid@or.nacdnet.net www.yamhillswcd.org

YAMHILL SWCD DIRECTORY

- Gordon Dromgoole, Director Zone 1
Barbara Boyer, Vice-Chair Zone 2
Leo Krick, Treasurer Zone 3
Michael Paine, Director Zone 4
Sam Sweeney, Director Zone 5
Jim LeTourneau, Chair At-Large
Dave Cruickshank, Director.... At-Large

ASSOCIATE DIRECTORS

- Alton Cronk Gordon Cook
Henry Wyman Lucien Gunderman
Mike Green Pat Fitzgerald

DIRECTORS EMERITUS

- Stan Christensen Patricia Farrell

YAMHILL SWCD STAFF

- Tim Stieber, Executive Director
Dean O'Reilly, Sr. Conservation Technician
Michael Crabtree, Sr. Conservation Planner
Amie Loop-Frison, Sr. Riparian Specialist
Josephine Reid, Office Administrator
Irma Koyama, Administrative Assistant

NRCS STAFF

- Leo Preston, Basin Team Leader
Chad Cherefko, District Conservationist
Kim Hudnall, Soil Conservationist
Rachel Russell, Program Assistant

Strategic Investments of FarmBill Dollars



In the conservation community the term "random acts of conservation" doesn't stir up heartfelt memories of good deeds done for the benefit for others. Rather it conjures up notions that maybe we need to take another look at how we invest our time and resources in Yamhill County. Much like how most of us have taken a second look at our budgets, trimmed the excess, and tightened our belt trying to get more out of each dollar we spend so too have we started dissecting how we spend our conservation dollars on the ground. No longer can we afford to spend our time, effort, and available funds on every good project that walks in our doors. Not to say we have not accomplished a lot of great work but instead we need to start asking ourselves "What is it we are getting for our money anyway?" Does this project further some greater need? Will this help solve a known resource problem? Do our projects make a difference on the ground?

So as the new Farmbill has finally gotten to our doorsteps we started asking these questions. The Yamhill SWCD, USFWS, TNC, NRCS, and the many members of the Yamhill Partners for Land and Water started working together to stop our shotgun approach and instead focus in on some key areas. So we have been working on developing areas within the County where we felt that concentrated efforts, by multiple partners, with a focused vision on a tangible outcome could help us resolve some Yamhill County's conservation challenges.

Three priority areas have emerged that we feel we can make a difference in. They are based an assessment of our current tools, staffing, know-how, financial assistance programs, expertise, community involvement and interest, and current investments. First is the North Yamhill River watershed which will be a focus on water quality due to DEQ 303D listings of dissolved oxygen, fecal coliform, and temperature. The second will be area focused on enhancing our rapidly diminishing oak savanna, oak woodland, upland prairie and wetland prairie habitats in the foothills and valleys that stretch from Sheridan to just NW of McMinnville. The last priority area will be the Chehalem Valley watershed that will have a land preservation focus for both wildlife and public uses such as recreation due to the rapidly expanding city of Newberg and the influence of the greater Portland area.

NRCS will be finding a better focus for its popular Farmbill programs that brought over \$1 million into the County last year. Although all lands within Yamhill County will still be eligible for contracts, programs like the Environmental Quality Incentives Program, Wildlife Habitat Incentives Program, and the Wetland Reserve Program will be prioritized to help resolve the conservation issues related to these priority areas.

NRCS is currently taking applications for funding through the EQIP, WHIP, and WRP programs. These include nutrient, pest, and irrigation management, irrigation systems, no-till, wildlife habitat enhancements, forestry planning, pre-commercial thinning and many other projects. So, come and invest with us! Contact us: 503-472-1474x101.

Chad Cherefko

District Conservationist
USDA-NRCS

NRCS—Helping people help the land. An Equal Opportunity Provider and Employer.

Attention Businesses

You could be reaching over 3,000 landowners by advertising in this space. A business card sized advertisement costs \$75 per Newsletter. Three issues per year. One year commitment.

To place an ad please contact Josie Reid at josie.reid@or.nacdnet.net or call 503-472-1474 ext 102.

You're Invited!

Yamhill SWCD conducts their regular Board meetings the 2nd Wednesday of each month, beginning at 7:30 AM. Board meetings are open to the public. Citizen attendance and input is encouraged. The Board meetings are held at the Miller Woods conference room, 15580 Orchard View Rd NW, McMinnville, Oregon. For more information or call the District @ 503-472-1474 x102

Grazing Management and Erosion Control

By Pat FitzGerald, FitzGerald Farms, LLC, Yamhill, OR

“Instead of managing grass, small grains, cattle (or horses) and wildlife for their own sake—we try to manage so they compliment one another. Wildlife production isn't a goal in and of itself. For us it's a measure of what's happening on the land. In our goal, we list wildlife as important to our quality of life and as essential in the future landscape....” says Gene Goven (2001), North Dakota Rancher and contributor to A New Environmental Intelligence. Working with North Dakota State University to study how well Gene's land is able to absorb the rainfall he receives. Neighboring areas average a water infiltration rate of about .8 inches/hour. With planned grazing, Gene has improved his land's water infiltration rate to 6.3 inches/hour. That means Gene's land is 8 times more able to retain and use water than neighboring properties, which in turn means there is less erosion, less flooding, and improved wildlife habitat. He has further increased his grazing season from 220 to 270 days and continues to see an increase in wildlife as well.



Wayne Burleson has worked with rancher Don Schaules in Montana to reclaim bare rangeland. In Don's right hand is a plant dug from a pasture one year after animals have been used to improve the health of the land. In Don's left hand, he holds the same species, Western Wheatgrass, dug on the same day from an area that had not been grazed for three years. The plants grew 30 feet apart from each other, but the unhealthy, dying specimen in Don's left hand has not had the invigorating effect of planned grazing.

So, is the title of this article a misnomer? Should we re-title it to “Planned Grazing's Effect on Erosion Control.”? Planned grazing differs from grazing management in that it considers the interrelationship of grazing management, herd density, pasture grasses, growth cycles, seasonal cycles, and biodiversity of the rangeland.

One might ask, how does this apply in high moisture areas such as Western Oregon, where winter rains provide abundant rainfall and snowfall? The answer is in the amount of moisture that can be retained in the range soils and their affect on biodiversity. Western Oregon can be very wet during the winter, the challenge is; however, how to best retain soil moisture (which reduces soil erosion) during the dry summer months without massive amounts of irrigation. As can be seen in our sample picture of a riparian habitat in Western Australia, the view of the left bank of the stream has been subjected to uncontrolled grazing and soil erosion baring roots and killing vegetation. To the right of the stream, one sees the benefits of planned grazing using intensive grazing techniques, re-introduction of native habitat, and planned periods of plant recovery; which have combined to produce a rich biodiverse habitat.



Australia
The land on the right is Holistically Managed. Both areas receive the same rainfall, with no irrigation. LOOK at the DIFFERENCE in EROSION!!

“An article in the January/February 2007 issue of *IN PRACTICE* by Keith Weber, Director of Idaho State University's GIS Training and Research Center, discussed the GIS Center's use of holistic Management methods...” and it's effects of various grazing treatments on rangeland health. Ms. Ferrin, employee of Idaho State University observes during their study of two adjoining sample rangelands, the rangeland offered the “treatment effects of holistic planned grazing yields a higher water content in the soil compared to rest-rotation or total rest treatments.”

(Holistic Planned Grazing) pasture, there was more litter because the concentration of cattle was six times greater than that found in RESTROT (rested) pasture. This litter affects soil moisture as the trampling of the cows breaks the crust of the soil and pushes plant litter into the soil. This litter acts as mulch, giving the soil more organic matter so that it can hold water better and also insulating the soil so that it is cooler and less water evaporates” And, I

(Continued on page 6)



December 2009

Newsletter of the Yamhill Basin Council: *Working to improve our watersheds.* **Volume 7, Issue 2**

New Art to Support the YBC

Purchase a limited edition "Kingfishers Courtship" print (right), painted by local artist Terry Peasley, and support the YBC. See the YBC website (www.co.yamhill.or.us/ybc) for prices and ordering information.



Yamhill Basin Council

- Kris Bledsoe *Chair*
- Bernie Hansen *Watershed Administrator*
- Milli Chennell *Watershed Coordinator*
- Denise Schmit *Monitoring Technician*
- Corissa Kunze *Monitoring Assistant*

Stakeholder Groups

- Agriculture
- Bureau of Land Management
- Business/Community Development Assoc.
- City Government
- Confederated Tribes of Grand Ronde
- Environmental Groups
- Industrial Forestry
- Natural Areas Parks & Recreation
- Students
- Small & Large Utilities
- Small Woodlands Assoc.
- Watershed Residents
- Yamhill & Polk Counties
- Yamhill SWCD

U-Bottle Water



A recent study by Oregon Department of Environmental Quality found that drinking tap water in refillable bottles is the more environmentally friendly action when compared with 48 different scenarios. The life cycle assessment included extracting raw materials, producing energy, water treatment, bottling, transportation, consumer transport, dishwasher use and disposal/recycling/composting. Even compared with bio-plastics, recycling single-use bottles and buying locally bottled water, refillable bottles had one fiftieth the global warming potential. The study suggests users of refillable bottles can further reduce their impact by using energy-efficient appliances,

washing bottles less often and only running the dishwasher when full. When you're ready to make the switch to refillable bottles, get your Yamhill Basin Council water bottle free, with a donation to the council. Email Milli Chennell at ybc_coordinator@co.yamhill.or.us or stop by the YBC office at 800 NE Second Street in McMinnville for more information.

YBC Welcomes Two New Employees

Yamhill Basin Council is pleased to introduce interim watershed coordinator Milli Chennell. Milli was born and raised in McMinnville and has volunteered with both Yamhill Basin Council and Yamhill SWCD. Having earned her Master's Degree in Environmental Science and Water Resources Management from the Bren School of Environmental Science and Management in Santa Barbara, Milli comes to us with diverse experiences, a wealth of knowledge and a passion for watershed stewardship. Milli hopes to aide the Council in this transition period as it explores new aspects of watershed management and community outreach.

In addition, the Council is pleased to introduce interim watershed administrator Bernadette Hansen. Bernadette comes to us with a broad background in water policy and water resource management. Bernadette worked for the Oregon Water Resources Department for nearly 15 years, serving as the Water Rights Transfer Program Coordinator the last five years. Bernadette has also worked in the private sector as a Resource Management Consultant. Bernadette looks forward to working with the Council and community to help make the Yamhill Basin a model of watershed stewardship in Oregon.

If you would like to join the council, there are openings for council members representing agriculture, business associations, small city governments and watershed residents. If you would like to be a part of our efforts, attend a council meeting on the second Thursday of every month from 7-8:30pm at the McMinnville Water Reclamation Center at 3500 NE Clearwater Drive, McMinnville. New council member applications are available on our website.

Newberg Water Wise Garden



The Newberg Water Wise Garden highlights sustainable gardening and building practices.

If you've driven through Newberg on 99W toward Dundee recently, you may have noticed a little bit more green. In less than a year the City of Newberg transformed a barren parking lot into a demonstration garden including a rainwater harvesting system and low-water irrigation. Driving by the corner of 99 and Blaine Street the informational kiosk is hard to miss with its living green roof. The Newberg Public Works project was accomplished with support from Yamhill County Master Gardeners, OSU Extension, Newberg High School and various businesses involved in sustainable gardening.

Though it features four unique low-water irrigation zones (donated by Ewing Irrigation and Hunter Industries), the garden is not only a demonstration of green watering practices. The development and building process was also a learning experience.

Bryan Stewart, the city grounds keeper who spearheaded the job, emphasized the learn-to-build course as one of the most exciting aspects of the project. The class offered by AquaScape taught the design and installation of rainwater harvesting systems. Around 70 contractors, builders and other professionals came to Newberg for this one-of-a-kind day



This fountain features collected rainwater.

course with both classroom and demonstration learning. The completed rainwater harvesting system feeds an attractive stone fountain at the foot of the informational kiosk.

It may come as a surprise that the renovated parking lot, which still contained a reduced number of parking spaces, is listed as Certified Wildlife Habitat. Along with installed birdhouses and feeders, the diverse plantings and water features of the garden provide food sources, water sources, places for cover, places to raise young and sustainable gardening practices, the criteria for certification. The obvious additions of habitat are the 2500 square feet of islands and borders planted with over 60 varieties of water-wise, wildlife inviting plants. Another area of habitat is over most visitors' heads. Although there are many benefits to green roofs, this one is primarily for urban habitat, the reduction of storm water runoff and filtering of pollutants. Other green roofs may be designed to lower heating costs, increase the roof's lifespan, and help insulate a building for sound. In spring the finishing touch of an educational sign pointing out the unique aspects of the garden will be added to the kiosk.

The convenient location of Newberg's water wise garden is perfect for a quick self-guided tour. Look around and you may just wind up with some new ideas for projects in your own garden. In a very small space this spectacular garden demonstrates a wide array of sustainable gardening practices, storm water retention systems and water-wise ideas and each of them can be used in private homes and businesses. For information on how to incorporate any of the ideas used at the water wise garden into your plans, contact Bryan Stewart, Newberg City Grounds Keeper, by email at bryan.stewart@newbergoregon.gov or by phone at 503-969-8620.

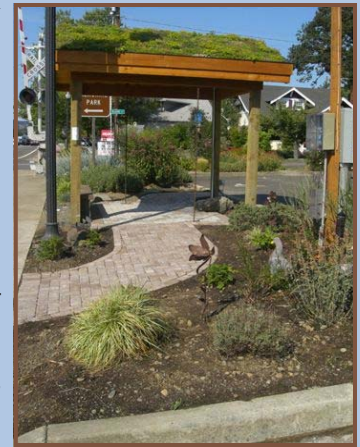

In spring the finished kiosk will feature an educational sign.



800 NE 2nd St
McMinnville, OR 97128
Phone: 503-474-1047
Fax: 503-472-2459
www.co.yamhill.or.us/ybc

Comments, questions, submissions? Wish to be added to or removed from the mailing list?

Contact Milli or Bernadette at (503) 474-1047 or ybc_coordinator@co.yamhill.or.us.



Grazing Management and Erosion Control continued

(Continued from page 3)

would add results in reduction of water runoff and erosion.

What can be gathered from this research? Utilizing these philosophies, we have been successful in improving biodiversity of our pastures at FitzGerald Farms. It is of interest to note that our primary business is horses, yet when these practices were employed, biodiversity of rangeland improved, grasses recovered faster, invasive species declined and a marked reduction in soil erosion was observed. Results were even more dramatic when cattle were introduced; however, that is a subject for another day. Suffice it to say that horses are very discriminating in their eating habits and cattle, being ruminants, are not; thus all of the edible material in a pasture gets consumed by cattle and less so when only horses are present.



This photo was taken in 1986 on some bare rangeland Don wanted to improve.



Here's the same area in May 1989 after Don used 600 cow-calf pairs to revitalize the landscape and provide a healthy habitat for a perennial grass species, Western Wheatgrass, to grow.



Fencing installed through USDA's EQIP on FitzGerald Farms that allows for rotational grazing.

The Yamhill SWCD was the missing link that allowed us to employ the planned grazing practices of Holistic Management through an EQIP grant which provided cost sharing for new water systems, manure management facilities, revised fencing, and specific sacrifice areas designed to get animals off the pasture during critical rest periods. The pictures to the left show the “wagon wheel” design of our pasture cross fencing, which is key to increasing our stocking levels, while allowing valuable periods of rest and recovery of habitat.

In closing, I want to credit the fine work of Alan Savory, founder of Holistic Management International. “Holistic Management International is a non-profit organization dedicated to restoring the health of degraded private, public and communal grasslands worldwide. By managing land resources in partnership with nature, we can increase land productivity, optimize water resources, preserve food sources, create sustainable livelihoods, and remove carbon dioxide from our atmosphere.

References

Ferrin, N. (2009). Grazing Affects Soil Moisture. *The Data Mine*. Retrieved November 29, 2009, from http://www.holisticmanagement.com/n9/Education/In_Practice/in_practice_archive.php
Goven, G. (2001) Enhancing Productivity. *A New Environmental Intelligence*. Retrieved November 29, 2009 from <http://www.holisticmanagent.com/n9/Education/new.envIRON/landrestore.pdf>
Savory, A. (2009) Holistic Management Website. *Holistic Management Works*. Retrieved November 29, 2009 from <http://www.holisticmanagement.com/index/html>

Miller Woods TRAIL SYSTEM

Please come and walk on the new trails at Miller Woods. There is something for everyone to see and enjoy. The trails pass through a variety of habitats, e.g. forests, streams, riparian, meadows, ponds and some special study sites, like oak savannah and forests being managed for bio-diversity.

Nearly 6 miles of trails have been constructed over the past four years, by the Yamhill Co. Oregon Youth Conservation Corp. Trail hiking condition ranges from easy (<5%) to moderately difficult (up to 10%). There are several loops and connecting way trails; Outer Loop – 4 miles, Education Loop Trail – 0.5 miles and many connecting trails – 1.5 miles.

Volunteers and staff have been working on planning and installing a trail route marking system using color coded arrows. A new map of the trail system has been completed and is located on the back of this page. Written descriptions of trail segments will soon be available. Mike Tippee of the U.S. Forest Service, Region 6, of Portland, Oregon, visited Miller Woods in September and was very helpful, in providing on site consultation, to help with the process of developing a trail signage plan.

Miller Woods is located, about 3.5 miles, W. of McMinnville. Follow Baker Cr.Rd. to Orchard View Rd., to 15580. Enter driveway entrance on right, follow down hill ¼ mile to parking lot. A visitor Kiosk, posts a map of the 130 ac. property and information about Miller Woods and its use. Open to the public, during daylight hours, seven days a week, except during special events. Visit www.millerwoods.org for more information. We hope you will come and visit, soon.



Volunteers Wendell Kringen & Sonya Wilkerson stand by one of the newly installed trail sign posts

How can you help support *Miller Woods*?

Miller Woods has been widely used by youth education programs and has been a great resource for outdoor lovers. There are several easy ways to support the outdoor education programs and activities ongoing at the property.

- 1) **Become a member supporter.** Your donation of at least \$35 provides much needed funds and is tax deductible. **Make your tax deductible donation payable to Natural Connections, Inc.** Membership allows access to hiking trails for an entire year. Membership forms can be downloaded from the Miller Woods web site www.millerwoods.org or can be found in the visitors kiosk at Miller Woods.
- 2) **Support the Annual Native Tree Sale** – most of the proceeds go toward Miller Woods.
- 3) **Donate** equipment, tools, or other supplies. Contact YSWCD to determine our needs.
- 4) **Volunteer** at our work days or propose a project that you'd like to complete for us.
- 5) **Spread the word to others** that might become members, buy native plants, donate supplies, or want to volunteer.



Miller Woods "A Unique Place to Learn About Natural Resources"

Legend

- Miller Woods
- Sign Posts
- Connecting Trail
- Education Station Trail
- Outer Loop Trail
- Service Road Trail
- Service Roads

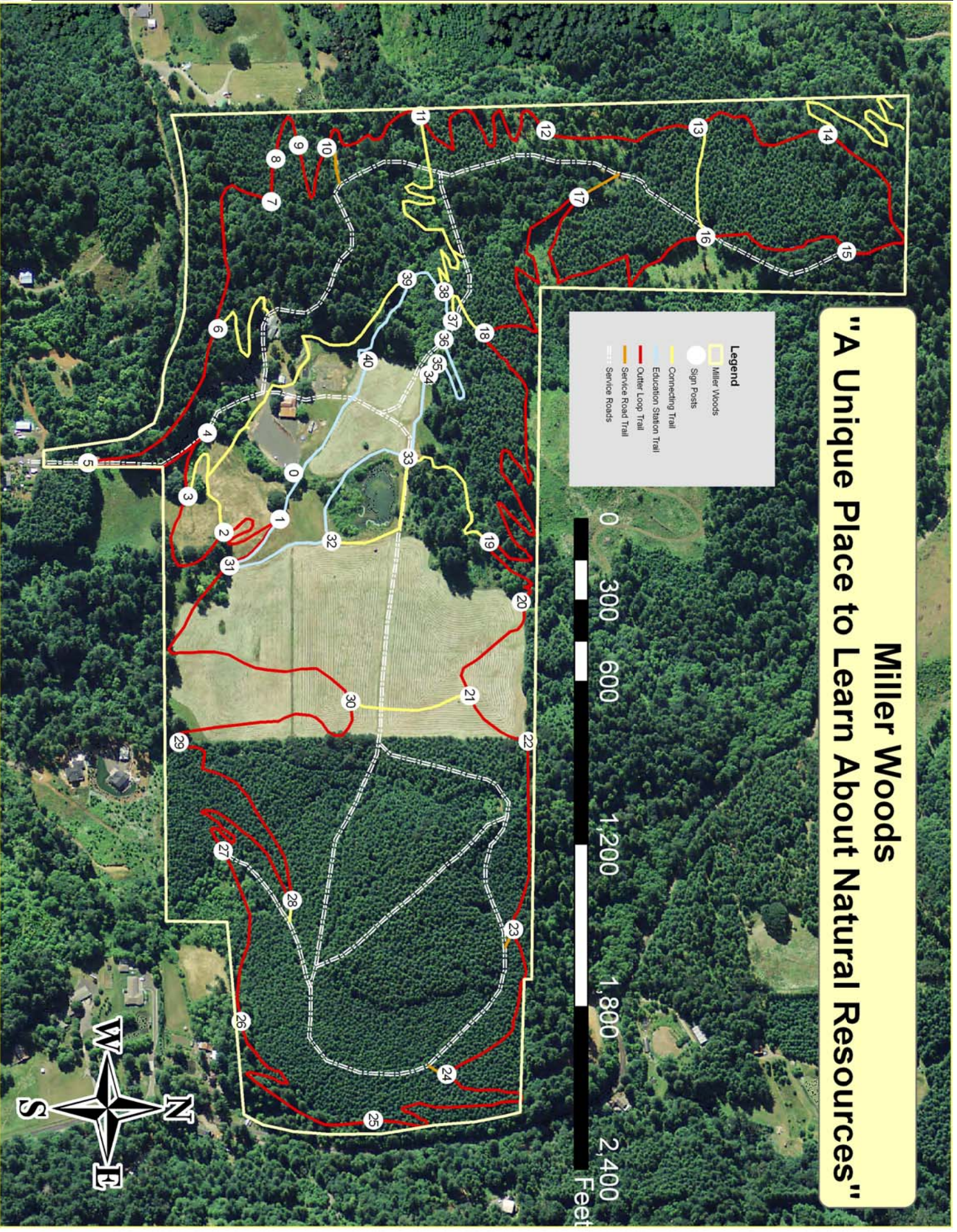



Land for the Long Term

New Partnership aims to encourage conservation for local economic, environmental vitality

Written by Will Neuhauser for publication in News-Register's Viewpoints Nov. 21, 2009

Will Neuhauser, co-chair with Patricia Farrell of the Yamhill Partners for Land & Water, lives just outside of Yamhill Ore., with his family. His experience includes: almost 30 years in the software and venture capital industries in Oregon and France, past chair of The Nature Conservancy in Oregon, current charter board member of the Virginia Garcia Memorial Foundation, and is involved with the Yamhill-Carlton Education Foundation as well as several other groups.



Yamhill County, mostly a rural county, is feeling the effects of its proximity to Portland and Salem, its attractiveness as a retirement area, the rapid growth of its two largest cities – McMinnville and Newberg – and the burgeoning wine industry and associated tourism. It is also has become an access route to the coast and the popular Spirit Mountain casino.

Although the county has a few natural assets secured for the long term, such as the Soil & Water Conservation District's Miller Woods, the (tiny but beautiful) Deer Creek County Park and the recent Nature Conservancy Yamhill Oaks preserve, we have fewer than 130 acres total combined in all our county parks – smaller than a single typical working farm!

Preservation

The long-term vitality of the Yamhill County area – both economically and for quality of life – is dependent on our natural areas and resources. Recognizing this fact, several public and private organizations involved in Yamhill County conservation activities, in parks, and in working lands began meeting in 2008 to discuss common issues and goals.

Over the course of several months, all agreed on the growing, unmet need for more stewardship county lands and waters, expanding opportunities for conservation and parks and increasing land-owner interest in helping create those areas through sale, donation and easements.

Specifically, the group noted :

- ◆ Limited capacity for conservation, especially limited funding;
- ◆ Challenges from a growing population and changing demographics;
- ◆ Shifting economic and agriculture base;
- ◆ Declining per-capita parks and park acreage, among the lowest of comparable Oregon counties;
- ◆ A crisis level loss of natural communities, especially of Oregon White Oak savannas and woodlands, and of upland and wet prairies;
- ◆ Poor water quality, especially turbidity, E. coli, and high temperatures in most streams and rivers;
- ◆ A generational transfer of lands underway with desire to preserve rather than convert lands; and
- ◆ Growing landowner interest in conservation easements but limited organizational capacity to respond.

Public-private partnerships

The result is the Yamhill Partners for Land & Water (www.yamhillpartners.org), a collaborative, community-based association. Our mission is “To conserve and enhance the lands and waters of Yamhill County for long-term economic and environmental vitality and enjoyment.”



Although a larger group of supporters is affiliated, today our active Partners are The Confederated Tribes of the Grand Ronde Community of Oregon, Friends of Yamhill County, The Nature Conservancy in Oregon, Three Rivers Land Conservancy, The Trust for Public Land, U. S. Fish & Wildlife Service, Yamhill Soil & Water Conservation District, Yamhill Watershed Stewardship Fund. Several other organizations are considering becoming partners.

(Continued on page 10)



(Continued from page 9)

The association has already helped a landowner develop funding for a wetlands restoration in the north Chehalem Creek, exchanged leads and support for conservation land acquisitions in the Muddy Valley area, shared knowledge of how federal funding can be better leveraged into the area and developed a conservation opportunity map of the county . The map shows habitat types and public ownership, consistent with Oregon’s wildlife strategy plan.

Collaboration has increased the efficiency of our groups so we can accomplish more conservation with limited staff and funding. But we have come to the conclusion that, to build a legacy of natural areas and resources in the county, our greatest need is more organizational and funding capacity.

Next steps for the Partners are :

- ◆ Develop a small set of key, shared, achievable strategic goals
- ◆ Increase awareness of the value of our characteristic natural areas and resources
- ◆ Increase community and landowner awareness of conservation and restoration needs and opportunities
- ◆ Investigate ways of increasing organizational and funding capacity



Conservation in Yamhill County is now a team sport!

The public and private partner organizations of the Yamhill Partners for Land & Water are working together to ensure a legacy of characteristic natural areas and resources for those who live, work and visit Yamhill County by conserving significant lands and waters for wildlife habitat, for working lands, and for parks and natural spaces to support the long-term vitality of the Yamhill region. For more information, visit <http://www.yamhillpartners.org> .

Planning Oregon’s Water Future

Oregon is currently one of only two western states without a formal statewide water management strategy that takes into account water quantity, water quality, and ecosystem needs such as fish spawning and rearing. The 75th Oregon Legislative Assembly passed HB 3369 in 2009 directing Oregon Water Resources Department (ODWR) to develop a strategic water resources strategy.



To learn more about ODWR’s new water resources planning effort the district recently invited Dr. Brenda Bateman from ODWR to speak at the district’s annual meeting October 15th in McMinnville. Over 100 residents attended the event. More recently the district co-hosted a water forum November 19th which featured Representative Jefferson Smith who co-sponsored HB3369.



Learn more at ODWR’s web site (www.wrd.state.or.us) where you can sign up to receive more information via email as the water strategy takes shape.



Yamhill SOIL & WATER CONSERVATION DISTRICT

2010 Native Plant Sale Order Form

Proceeds benefit Miller Woods Educational Program

Sale & Distribution Dates/Times: Feb. 11 & 12 (9am-6pm) & Feb. 13 (9am-3pm)

Pre-Order Forms will be accepted through Friday, February 5, 2010

Quantity	Item No.	Common Name	Scientific name	Plant Size	SWCD Sale \$	Total
	1	Coastal Redwood	<i>Sequoia Sempervirens</i>	T-Pot 4"x 14"	\$ 4.00	\$
	2	Douglas Fir (251)	<i>Pseudotsuga menziesii</i>	BR 12" + 2-0	\$ 0.50	\$
	3	Giant Sequoia	<i>Sequoiadendron giganteum</i>	BR 8" 1-0	\$ 0.60	\$
	4	Grand Fir (251)	<i>Abies grandis</i>	BR 12"+ 2-0	\$ 0.60	\$
	5	Incense Cedar	<i>Calocedrus decurrens</i>	BR 12"+	\$ 0.60	\$
	6	Noble Fir	<i>Abies procera</i>	BR 10"+ 2-0	\$ 0.60	\$
	7	Pacific Yew	<i>Taxus brevifolia</i>	Pot	\$ 1.50	\$
	8	Western Hemlock	<i>Tsuga heterophylla</i>	BR 12"+ 2-0	\$ 0.60	\$
	9	Western Red Cedar	<i>Thuja plicata</i>	BR or P1 12"+	\$ 0.60	\$
	10	W.Valley Ponderosa Pines	<i>Pinus ponderosa</i>	BR 12"+ 2-0	\$ 0.60	\$
	11	Bigleaf Maple	<i>Acer macrophyllum</i>	BR 18" +	\$ 0.75	\$
	12	Black Cottonwood	<i>Populus trichocarpa</i>	BR 18"-36"	\$ 0.75	\$
	13	Cascara	<i>Rhamnus purshiana</i>	BR 12-24"	\$ 0.75	\$
	14	Indian Plum	<i>Oemleria cerasiformis</i>	BR 12" +	\$ 1.00	\$
	15	Oregon Ash	<i>Fraxinus latifolia</i>	BR 12 to 24"	\$ 0.75	\$
	16	Pacific Crabapple	<i>Malus fusca</i>	T-Pot 18 - 36"	\$ 1.50	\$
	17	Red Alder	<i>Alnus rubra</i>	BR 24"+	\$ 0.75	\$
	18	Vine Maple	<i>Acer circinatum</i>	BR 12"-18"+	\$ 1.00	\$
	19	Elderberry - RED	<i>Sambucus racemosa</i>	T-Pot 12"+	\$ 1.50	\$
	20	Evergreen Huckleberry	<i>Vaccinium ovatum</i>	Small Pot	\$ 2.50	\$
	21	Kinnikinnick	<i>Arctostaphylos uva-ursi</i>	3.5" pot	\$ 2.50	\$
	22	Nootka Rose	<i>Rosa nutkana</i>	BR 12"+	\$ 0.75	\$
	23	Oregon Grape-Tall	<i>Mahonia aquifolium</i>	3.5" pot	\$ 0.75	\$
	24	Pacific Ninebark	<i>Physocarpus capitatus</i>	BR 12"-18"+	\$ 0.75	\$
	25	Pacific Rhododendron	<i>R. macrophyllum</i>	small pot	\$ 3.50	\$
	26	Red Flowering Currant	<i>Ribes sanguineum</i>	BR 18"+	\$ 1.00	\$
	27	Red Osier Dogwood	<i>Cornus sericea</i>	BR 18"+	\$ 0.75	\$
	28	Salal	<i>Gaultheria shallon</i>	3.5" pot	\$ 2.50	\$
	29	Serviceberry	<i>Amelachier alnifolia</i>	BR 12"+	\$ 0.75	\$
	30	Snowberry	<i>Symphoricarpos albus</i>	BR 12"+	\$ 1.00	\$
	31	Twinberry	<i>Lonicera involucrata</i>	BR 12"+	\$ 1.00	\$
	32	Western spirea	<i>Spiraea Douglasii</i>	BR 12"+	\$ 0.75	\$
	33	Bleeding Heart	<i>Dicentra formosa</i>	2.5 x 5" Pot	\$ 2.50	\$
	34	Bunchberry	<i>Cornus canadensis</i>	2.5 x 5" Pot	\$ 2.50	\$
	35	Great Camas "White"	<i>Camassia leichtlinii</i>	2.5 x 5" Pot	\$ 2.50	\$
	36	Larkspur	<i>Delphinium menziesii</i>	2.5 x 5" Pot	\$ 2.50	\$
	37	Mariposa Lily	<i>Calochortus tolmiei</i>	2.5 x 5" Pot	\$ 2.50	\$
	38	Oregon Fawn Lily	<i>Erythronium oregonum</i>	Round Elle Pot	\$ 2.50	\$
	39	Oregon Iris	<i>Iris tenax</i>	2.5 x 5" Pot	\$ 2.50	\$
	40	Penstemon	<i>Penstemon cardinalis</i>	2.5 x 5" Pot	\$ 2.50	\$
	41	Red Columbine	<i>Aquilegia formosa</i>	2.5 x 5" Pot	\$ 2.50	\$
	42	Yellow Monkey Flower	<i>Mimulus guttatus</i>	2.5 x 5" Pot	\$ 2.50	\$
	43	Tree Protectors - 24 inch mesh tubes with bamboo stakes		Bundle of 10	\$ 7.50	\$
A= B= C= D= E=	44	Posters: A=Broadleaf, B=OldGrowth, C=Conifer, D=Sequoia, and E=Hedgerows		36"x24"	\$ 6.00	\$
F= G= H=	45	Posters: F=Rain Garden, G=Garden Herb, H=Low Impact living		18"x24"	\$ 5.00	\$

Cash or Check ONLY

Handling/Packing Fee (pre-orders only)

\$2.50

Customer Name: _____

TOTAL \$

Quantities are limited - all items are subject to availability



CUSTOMER INFORMATION

Name:

Address:

City:

State:

Zip:

Phone:

Email:

Thank you for your support!

ORDER INSTRUCTIONS

- 1) Consult reference materials to select appropriate plants.
- 2) Complete the order form and return with Customer Information Sheet by any of the following ways:

Yamhill Soil & Water Conservation District

2200 SW 2nd Street, McMinnville, OR 97128

FAX to (503) 472-2459

Email to josie.reid@or.nacdnet.net

- 3) We recommend that you MAKE A COPY of your order form for your records.
- 4) Please DO NOT SEND PAYMENT with your order form.
- 5) Please MARK YOUR CALENDAR. We will not be able to send out reminders.

You can pick up your order Feb. 11 & 12, 9 a.m.- 6 p.m., & Feb. 13, 9 a.m.- 3 p.m.

- 6) We will be accepting CASH or CHECK ONLY.

To keep prices down we will not be able to accept credit or debit card payments this year.

- 7) Orders will be filled in the order received and according to availability.

QUANTITIES ARE LIMITED

YAMHILL SWCD 2010 NATIVE PLANT SALE

Plant Descriptions

(See legend on reverse side)

Name	Mature Height	Sun	Soil Conditions	Special Uses	Notes
Coastal Redwood <i>Sequoia sempervirens</i>	200'	A-B	Moist	3	Can be used in landscape settings if irrigated or roots have access to supplemental water. Large potted plants.
Douglas Fir <i>Pseudotsuga menziesii</i>	200+'	A	Grows on all but wettest soil	Timber 1, 2a	Oregon's state tree can live over 1000 years. Thick bark enables it to survive moderate fire.
Giant Sequoia <i>Sequoiadendron giganteum</i>	200+'	A	Prefers well drained sites.	3	Excellent specimen tree. Dense gray-green foliage and reddish brown bark. Northern California native.
Grand Fir <i>Abies grandis</i>	200+'	A-B	Dry to Moist	Timber 1, 2a	Tall, straight, stately fir with grayish-brown bark. Grows in same environment as the Douglas Fir.
Incense Cedar <i>Calocedrus decurrens</i>	100+'	A	Moist sites	2a, 3	Attractively shaped conifer with dense foliage, often used in home landscapes. Wood has pleasant odor.
Noble Fir <i>Abies procera</i>	100+'	A	Prefers deep, rich soils	Christmas Trees	Beautifully symmetrical, conical shape, bark smooth with resin blisters when young. Desirable for Christmas tree.
Pacific Yew <i>Taxus brevifolia</i>	20' - 50'	B-C	Prefers moist soil	2a, 3	Bright fleshy fruit attractive to birds. Foliage is used as winter browse by deer and elk.
Western Hemlock <i>Tsuga heterophylla</i>	50' - 100'	A-C	Fairly dry to wet sites	Timber 2a, 3	Attractively shaped, adaptable conifer, seedlings prefer to develop under shade. Seeds important food source for birds and small mammals.
Western Red Cedar <i>Thuja plicata</i>	180'	B	Moist sites	Timber 1, 2a, 4	Excellent for wildlife cover and for restoration projects, and as an ornamental. Fragrant wood and foliage.
Willamette Valley Ponderosa Pine <i>Pinus ponderosa</i>	180'	A	Adaptable – grows on wet and dry sites.	Timber 3	Native pine to Willamette Valley. Popular for its straight growth habit that exposes scaled, colored bark with a vanilla fragrance.
Bigleaf Maple <i>Acer macrophyllum</i>	100'	A-B	Well drained soil	Timber 1, 2a	Supports mosses, ferns and lichens and provides seeds for wildlife. Yellow fall color. Excellent shade producer.
Black Cottonwood <i>Populus trichocarpa</i>	180'	A	Flood plains	Timber 2a, 3, 4	Fast growing with dark gray bark. Important browse for deer and elk. Nesting habitat for large birds.
Cascara <i>Rhamnus purshiana</i>	30'	B-C	Wet to fairly dry	3, 4	Erect tall shrub or small tree to 30ft with smooth, silver-grey bark. Glossy green leaves, greenish-yellow small flowers.
Indian Plum <i>Oemleria cerasiformis</i>	16'	A-B	Dry to moist soil	1, 2a, 2b	One of first plants to bloom (Jan. Feb.). White flowers yield small purple edible plums. Highly sought by birds.
Oregon Ash <i>Fraxinus latifolia</i>	75'	A	Wet areas and floodplains	Timber 4	Grayish-brown bark and olive green leaves. Good restoration species in poor soils. Abundant seed producer.
Pacific Crabapple <i>Malus fusca</i>	36'	A-B	Moist soils near wetlands	2a	Native apple with fragrant blossoms producing small green to red fruit. Red and yellow fall color.
Red Alder <i>Alnus rubra</i>	100'	A	Moist soils, wet areas	Timber 1, 2a, 2b	Good species to plant along streams to provide shade and erosion control.
Vine Maple <i>Acer circinatum</i>	25'	A-C	Moist soils	1, 2a, 2b	Attractive fall colors. Suitable for shade, ornamental, or forest under-story plant.
Elderberry –RED <i>Sambucus caerulea</i>	15'	A-C	Moist	1, 2a, 2b	Produces white flowers and bright red berry-like clusters by summer that are highly sought by birds.
Evergreen Huckleberry <i>Vaccinium ovatum</i>	10'	A-B	Prefers well drained soils	1, 2a, 2b, 3	Inconspicuous pink flowers are followed by showy dark purple berries which ripen in early autumn.



Name	Sun	Soil Conditions	Special Uses	Notes
Kinnikinnick 12" <i>Arctostaphylos uva-ursi</i>	A-B	Prefers well drained soils.	2a, 3, 4	Attractive ground cover usually less than 12" tall with dark green leaves and red, edible, but tasteless berries.
Nootka Rose 6' <i>Rosa nutkana</i>	A	Dry, well drained sites	1, 2a, 2b	Forms dense clumps with large pink flowers. Fruit eaten by birds and small mammals. Browse for deer and elk.
Oregon Grape – Tall 5-10' <i>Mahonia aquifolium</i>	A-C	Dry to fairly moist.	1, 2a, 2b, 3	State flower of Oregon, having holly like leaves and dark blue edible berries.
Pacific Ninebark 10' <i>Physocarpus capitatus</i>	A-C	Moist soils along wetlands	2a	Large spreading, attractive shrub with rounded clusters of white flowers. Maple like leaves, thin shredded bark.
Pacific Rhododendron 15' <i>Rhododendron macrophyllum</i>	A-C	Moist to fairly dry	1, 2a, 2b,3	Evergreen with pink to rose-purple, bell-shaped flowers. State flower of Washington.
Red Flowering Currant 10' <i>Ribes sanguineum</i>	A-B	Best on well drained soils	1, 2a, 2b	Beautiful ornamental shrub with white, pink, to deep red flowers that attract butterflies and hummingbirds.
Red Osier Dogwood 12 ' <i>Cornus sericea</i>	A-C	Moist soils along wetlands	1, 2a, 2b, 3, 4	Attractive red stems with white flower cluster that produces white berry clusters. Fast growing.
Salal 6' <i>Gaultheria shallon</i>	A-C	Well drained soils	1, 2a	Dark green, lustrous leaves, white or pink flowers after establishment. Good forest understory species.
Serviceberry 16' <i>Amelanchier alnifolia</i>	A-B	Dry to moist, well drained	1, 2a, 2b, 3	Grows to 16ft tall. Fruits are dull-red, becoming purple to blackish, edible, sweet and popular with birds.
Snowberry 6' <i>Symphoricarpos albus</i>	A-B	Grows on dry to moist sites	1, 2a, 2b	Adaptable shrub having attractive foliage and clusters of waxy white berries that persist through winter.
Twinberry 10' <i>Lonicera involucrata</i>	A-B	Moist, well-drained	2a,2b,3	Grows in moist forest clearings, streamsides, swamps, and thickets. Flowers are yellow & tubular; berries are paired and bitter-tasting. Often used as ornamental plant.
Western Spirea 3-6' <i>Spiraea douglasii</i>	A-B	Wet to moist soils	1	Erect leggy shrub producing pinkish purple flower blooms during July. Attractive ornamental. Great for pollinators.

OTHER PLANTS AND PRODUCTS AVAILABLE

Bleeding Heart <i>Dicentra formosa</i>	Fern like perennial (1ft. tall) with pinkish-purple heart shaped flowers forming clusters. Prefers moist, shady conditions in forests or along streams or among other garden plants.			
Bunchberry <i>Cornus canadensis</i>	A low deciduous shrublet preferring moist, well-drained soils. Grows in partial to full shade in cool acidic soils. Flowers are tiny white clusters surrounded by four large white bracts.			
Great Camas 'White' <i>Camassia leichtlinii</i>	Bulb produces a tall stem with bright white starflowers which open at the bottom and work their way upwards, ensuring long bloom time. Prefers full sun to partial shade.			
Larkspur <i>Delphinium menziesii</i>	Short perennial from tuberous roots. Prefers moist, well-drained soil in cool, moist summers. Grows in full sun to partial shade. Flowers are deep blue to purplish which are clustered at stem tops.			
Mariposa Lily <i>Calochortus tolmiei</i>	Has branched stems and white to cream-colored flowers, often tinged with purple or rose but unspotted. Grows in open forests, dry meadows, and dry, rocky slopes.			
Oregon Fawn Lily <i>Erythronium oregonum</i>	Perennial herb with white flowers marked with orange-yellow at the base. Grows in well-drained, open, often grassy areas.			
Oregon Iris <i>Iris tenax</i>	Perennial herb that resembles commercial iris varieties. Grows in clumps with purple to blue flowers. Foliage makes a nice border. Tolerates a range of soil conditions.			
Penstemon <i>Penstemon cardinalis</i>	Upright perennial reaching 3-5' tall. Prefers full sun and well-drained soil. Flowers are bright red and hang gracefully off the flower stalk and are highly attractive to hummingbirds.			
Red Columbine <i>Aquilegia Formosa</i>	Erect perennial herb (to 3') with soft foliage and ornate drooping red to yellow flowers. Likes moist, open to partially shaded sites in the forest or in flower beds.			
Yellow Monkey Flower <i>Mimulus guttatus</i>	Flowers are yellow, trumpet shaped and long-stalked. Grows in wet ledges, crevices, weeping rock faces, seepage areas, along streams, near springs, on gravel bars, in wet ditches & clearings.			
Tree Protector Mesh	Deer browsing can make plant establishment difficult in many areas. Rigid, biodegradable (2 – 3 years), mesh tubes that help minimize deer damage. Each 24" mesh tube comes with a 3 foot bamboo stake.			
Assorted Potted Plants	Available - First Come- First Serve Basis: Ferns, Camas, Port Orford Cedar, Sequoia, Western Larch, Western Hemlock, Highbush Cranberry, Incense Cedar, Inside-out Flower, Shore Pine, Madrone, Red Huckleberry, Goat's Beard, Harvest Brodiaea, Oregon Oxalis, Trillium, and many other hard-to-find plants.			

LEGEND

Sunlight Conditions : **A**= Prefers full sun **B** = Can tolerate sun or some shade **C** = Prefers shade

Special Uses : **1** Attracts insects, bees, butterflies **2a** Birds **2b** Hummingbirds **3** Wildlife, forage, cover, food **4** Bank stabilization



Conservation Quiz – Native Plants

By Amie Loop-Frison

This Conservation Quiz will focus on native plants. We relied heavily on the text “*Plants of the Pacific Northwest Coast*” by Pojar and Mackinnon to develop this quiz.

- 1.The earliest blooming native shrub in the spring.
- 2.When ingested, the bark from this acts as a natural laxative.
- 3.The state flower of Oregon.
- 4.This branches of this tree carries a greater load of mosses and other plants than any other species in our region.
- 5.Native Americans braided the leaves of this flower into snares which were strong enough to catch an elk.
- 6.This flower’s name has opposing directions
- 7.Native to Western Oregon, but also the state flower of Washington.
8. The tree of choice for vulnerable wildlife species including western gray squirrels, acorn woodpeckers, white breasted nuthatches and western bluebirds.



8.Oregon White Oak

5.Oregon Iris 6.Inside Out Flower 7.Pacific Rhododendron

1.Indian Plum 2.Cascara 3.Oregon Grape 4.Bigleaf Maple

Answers:

Jacobs Wetland

By: Michael Crabtree

In the spring of 2009 the Yamhill SWCD completed a wetland



Western Bluebird Box



Raptor Pole

project on Jeff Jacobs property in McMinnville. The project was designed to create a wetland filter that will clean roadside rainwater runoff that eventually flows into the Yamhill River. Originally, the ditch on Riverside Loop ended at a field on Jeff’s property. The water was left to flow overland

about 200 yards and then into the River. This was causing the trees that Jeff had recently planted through the Conservation Reserve Enhancement Program (CREP) to die. The Yamhill Soil and Water Conservation District designed a pipeline that delivers the excess water through the CREP project and into a small wetland at the edge

of the field. The water is then filtered by wetland plant species so that clean water will enter the river. First, the non-native and invasive species were removed from the site. Then, the wetland area was planted with a mix of Meadow barley, Spiked bentgrass, Slender hairgrass and a variety of sedges, rushes, trees and shrubs. Also, various nesting boxes and perches were installed over the project area to promote wildlife habitat. The targeted wildlife species were the Barn Owl, the Western Bluebird, the Wood Duck and the Mallard.

The project was funded using Oregon Watershed Enhancement Board (OWEB) small grant program.



Mallard Box



Mallard Box with Wood duck box in the background



2200 SW 2nd Street
McMinnville, OR 97128
Tel.: (503) 472-1474 x102

NONPROFIT
ORGANIZATION
U.S. POSTAGE
PAID
McMinnville, OR
Permit No. 77

Inside this issue

- SWCD News.....Pg.1
- NRCS:Chad Cherefko.....Pg. 2
- Grazing Management...Pg 3&6
- YBC NewsletterPg.4 & 5
- Miller Woods update.....Pg 7
- MW NEW Trail MapPg 8
- Land for the Long-term....Pg 9
- Oregon's Water Future....Pg10
- Plant DescriptionsPg 11,12
- NPS Pre-Order Form.Pg13,14
- Conservation Quiz ...Pg 15
- Jacobs Wetland Project Pg 15
- NPS Posters.....Pg 16



Conservation Notes – 16

A



B



C



D



****POSTERS ON THE PRE-ORDER FORM****

E



F



G

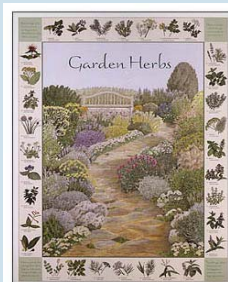

H

